



SmartOffice PS286 Plus

Workgroup class 25 page per minute document scanner that can scan plastic cards and business documents. TWAIN drivers ensure compatibility with thousands of imaging and document management applications.



Scans a variety of document formats

In addition to standard two sided business documents up to 14" long, the SmartOffice PS286 Plus can also scan:

IDs and Business Cards

Any rigid ID card up to 1.2mm thick.

A3 Sized Documents

A3 sized documents can easily be scanned using the special stitch mode and included special document imaging folder.



Scan with the touch of a button!

Create searchable PDFs, scan to e-mail, scan to FTP, OCR, BCR, copy, or file documents by simply pressing a button. Nine different scanning jobs or functions can be easily setup to meet your scanning needs.

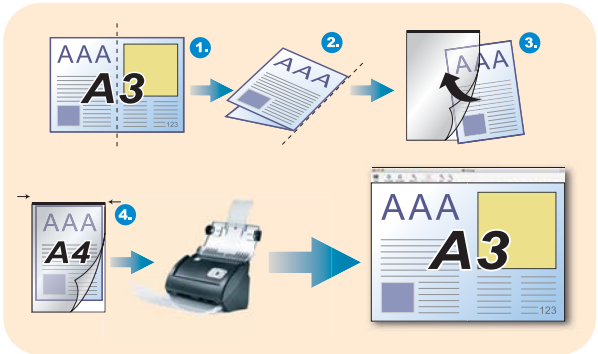

TWAIN drivers and software bundle

The SmartOffice PS286 is bundled with a suite of document management and scanning applications that allow you to be productive right out of the box. In addition to searchable PDF, the SmartOffice PS286 can create all popular image file formats and editable Microsoft Office files. Industry standard TWAIN and WIA drivers ensure compatibility with thousands of image enabled applications.





SmartOffice PS286 Plus



Automatic Image Processing

Auto deskew

Automatic deskew automatically straightens crooked images.

Automatic page size and auto crop

Automatically detects paper size and crops scanned images to the correct dimensions.

Color dropout

Increase forms processing accuracy by eliminating red, green or blue printed forms.

Blank page removal

Automatically remove blank pages after the document is scanned.

Automatic Thresholding

Automatically adjusts for darker or lighter areas on a document when scanning in black and white. Automatic Thresholding eliminates the need to manually adjust contrast and threshold for each page.

Specifications

Optical Resolution	600 dpi
Max. Hardware Resolution	600 x 600 dpi
Technology	Color Contact Image Sensor (CIS)
ADF Capacity	1. 50 sheets (A4/Letter, 70 g/m ² or 18 lb.), Max. thickness under 5mm (0.2"). 2. 20 sheets (Business Cards) 3. Plastic Card, Max. thickness under 1.2 mm. Note: Maximum ADF capacity varies, depending upon paper weight.
ADF Scanning Speed	8 ppm/8 ipm (200 dpi, color mode, A4 Portrait) 25 ppm/50 ipm (200 dpi, grayscale mode, A4 Portrait) 25 ppm/50 ipm (200 dpi, B/W mode, A4 Portrait) Note: Results may vary depending upon your scanning application, computer processor and system memory.
Scan Area(W x L)	Max. 216 x 356 mm (8.5" x 14") / Min. 13.2 x 13.2 mm (0.52" x 0.52")
Acceptable Paper Sizes (W x L)	Max. 220 x 356 mm (8.66" x 14") / Min. 50.8 x 50.8 mm (2" x 2")
Acceptable Paper Weight for ADF	50 to 105 g/m ² (14 to 28 lb.)
Daily Duty Scan (Sheets)	1500
Roller Lifetime (Scans)	100000 (Customer replaceable)
Pad Lifetime (Scans)	20000 (Customer replaceable)
Power Adapter	24Vdc, 0.75 A
Interface	USB 2.0 High Speed
9 Function Keys	Scan, Copy, OCR, File, E-mail, Scan, Copy, BCR, File
Physical Dimensions(W x D x H)	263 x 127.5 x 148 mm (10.36" x 5.02" x 5.83")
Weight	1.66 Kgs (3.66 lb.)
Protocols	TWAIN Compliant

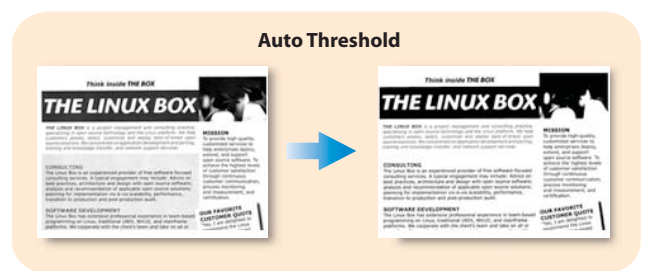
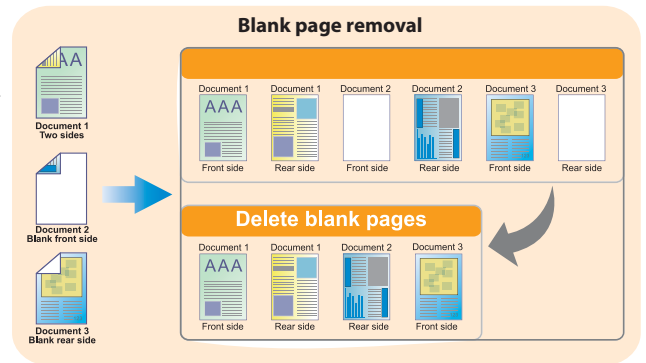
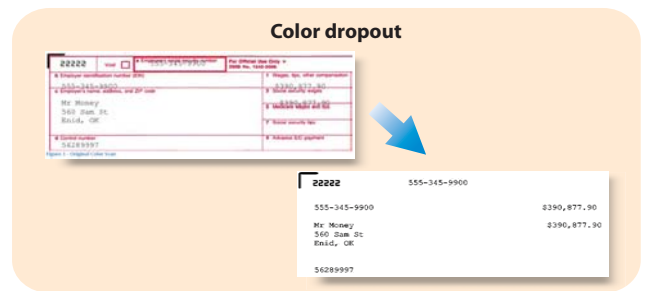
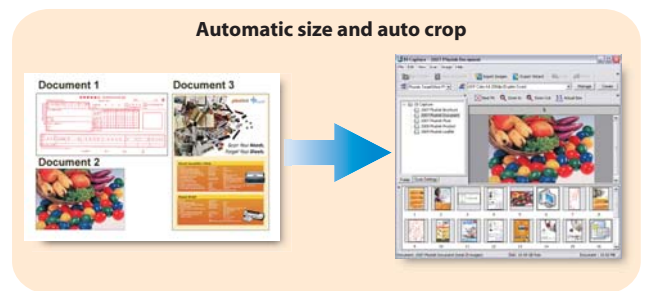
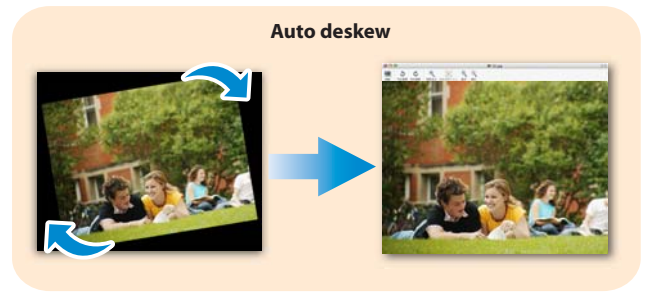

For more info: SalesUSA@plustek.com



As an international ENERGY STAR Partner, Plustek has determined that this product meets the international ENERGY STAR Program for energy efficiency.



© 2010 by Plustek Inc. All rights reserved. All registered trademarks are the property of their respective owners.